

HOPE HAVEN

Reviving Lives, Rebuilding Homes:
Joining Hands for Pakistan's Flood-Affected!



CAD1200



FROM CONCEPT TO CONCRETE: A COMPREHENSIVE HOUSE CONSTRUCTION BLUE PRINT



Lights & Fan Installation

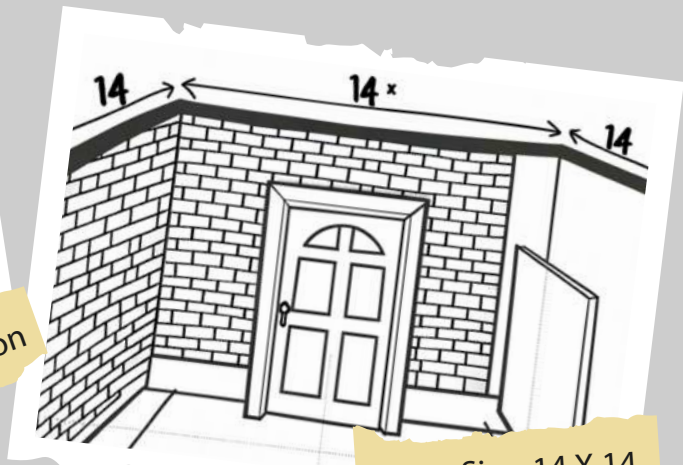

Room Size 14 X 14

Wall Thickness 9 Inch



TR Garder Roof



Electric Wiring in the Room

Room Height 11Ft – 16Ft

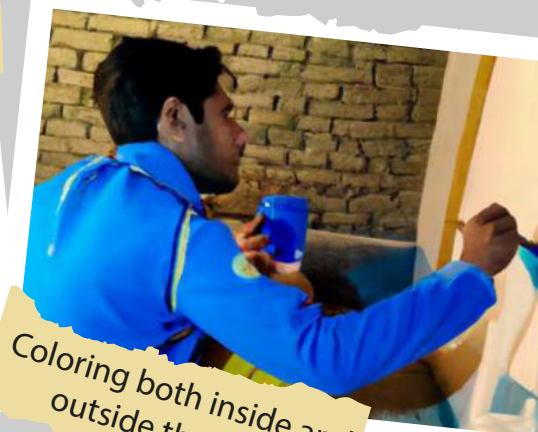

Coloring both inside and outside the room



Steel Door

FREQUENTLY ASKED QUESTIONS

What are the key differences between a 4-inch wall and a 9-inch wall in construction, and how do these variations impact structural integrity, insulation, and overall building performance?

The difference between a 9-inch wall and a 4-inch wall lies primarily in their thickness. A 9-inch wall is thicker and generally preferred for increased stability and durability, while a 4-inch wall is thinner and may have different structural properties, often used in different contexts where space or other factors are considerations. We prioritize working with the 9-inch walls for enhanced long-term stability.

Would reducing the wall thickness from 9 inches to 4 inches significantly reduce the overall construction cost of a house?

Constructing with 4-inch walls can indeed reduce costs, but it's crucial to consider their inherent risk. These walls may lack durability, especially in harsh weather, potentially leading to structural issues or damage. Additionally, in case of any unfortunate incidents causing casualties or fatalities due to the wall's limitations, there might not be any recourse for reimbursement or compensation for the losses incurred. Balancing cost-effectiveness with safety is essential in construction decisions.

Why do you use TR Garder for roofing purposes, and if so, what are the reasons for its use on roofs?"

The selection of TR Garder for the roof demonstrates our dedication to flood-proofing measures, which is particularly important in flood-prone areas. This decision aims to safeguard against water damage, potentially preventing financial losses associated with flooding events.

Do you provide anything physical, apart from the construction of a home?

Certainly! Installing ceiling fan and lights is a standard procedure in the construction of a new house.

Do you include the construction of a toilet in the process of building a house?

Typically, toilets are found outside homes, and as a result, there is no need to build them within the house.

In what ways can homeowners actively participate in and contribute to the construction process of their own house?

The homeowners for whom we are building actively

participate in the construction process, and we honor any requests they may have within the specified budget.

How do you ensure and uphold quality standards?

We prioritize quality, refusing to compromise on it. Our commitment lies in delivering long-lasting solutions based on this belief in quality. Therefore, Our construction costs may seem high due to our use of a 9-inch wall for enhanced durability and TR Garder for the roof to ensure flood resistance. While these choices contribute to an initial higher investment, they offer significant advantages in terms of long-term durability and protection against flooding.

Who is responsible for constructing houses?

We hire contractors who have been thoroughly vetted to construct the houses. Our on-ground team supervises the contractors throughout the entire process to ensure integrity and transparency.

How do you choose the location?

We have been working to provide assistance and support to people affected by the last Flood in Sindh, the trust has initiated a project to build durable and comfortable houses for the affected families who lost their homes in the 2022 floods.

Do I get to see where my money goes?

Certainly! As soon as the house is built, we send videos of the entire process along with the GPS coordinates of the exact location of the house.

Does any money from my donation go towards overhead costs?

We don't keep a single dollar from your donation. If there are any expenses related to overhead costs, our volunteers cover them. Therefore, the project cost matches the value of our payment to the vendor.

Is the organization's logo 'Pani' and the trust name 'Az'zariya Welfare Trust' representing the same entity, or are they two different organizations?"

We initially started with the name "Pani," but when applying for trust registration, the authorities rejected "Pani" as a suitable name. As a result, we proceeded to register NGO under the name "Az'zariya Welfare Trust," and the organization is currently in the registration process. Az'Zariya means bridge between donors and recipients.

PROJECT COMPONENTS FOR COMPREHENSIVE ROOM CONSTRUCTION

Sturdy Walls: Built with 9-Inch walls, providing stability and resilience. A 9-inch wall offers increased structural strength, enhanced thermal and sound insulation, as well as improved fire resistance, making it a versatile choice for buildings where durability, safety, and environmental control are priorities.

TR Garder Roof: The room is equipped with TR Garder roofing, renowned for its durability and robust construction, ensuring long-lasting protection against the elements. This advanced roofing solution not only enhances the structural integrity of the space but also provides a reliable shield, standing resilient against adverse weather conditions. With TR Garder roofing in place, occupants can enjoy peace of mind, knowing that their environment is safeguarded by a high-quality and enduring roofing system.

Elegant Interiors: The smooth and seamless plastering on the walls reflects a meticulous attention to detail, showcasing a level of craftsmanship that elevates the overall aesthetic of the space. The expertly applied plaster not only enhances the visual appeal but also contributes to a sense of durability and longevity. The polished finish exudes a timeless elegance, creating an inviting atmosphere that complements the interior design.

Vibrant Ambiance: The room's vibrant ambiance is achieved through a thoughtful selection of soothing colors, creating an instantly welcoming atmosphere. Soft pastel blues and gentle greens harmonize to form a tranquil haven, enveloping visitors in a sense of calm. The interplay of natural light enhances this vibrant energy, making the room a refreshing and uplifting space for relaxation.

Secure Entrances: The installation of a robust and fortified main door stands as a testament to our commitment to enhancing both the security and aesthetics of our premises. This state-of-the-art entrance not only bolsters the safety of our space but also adds a touch of sophistication to the overall architectural appeal. The newly fixed main door symbolizes our dedication to creating a secure and visually pleasing environment for all occupants.

Electrical Setup: The professionally installed electrical wiring ensures a reliable and safe power supply throughout the room, meeting industry standards for both functionality and safety.

Comfortable Climate: Room is fitted with new fans and lights for a comfortable living environment. The newly installed lights not only illuminate the space effectively but also contribute to a warm and inviting ambiance, enhancing the overall comfort of the living environment.

H



O



U



S

CONSTRUCTING HOPE FOR THE HOMELESS

E



100% Donation Policy

A 100% donations policy means every single penny donated is used strictly for charitable efforts. Donations go into a 'charity-only' bank account from which nothing is removed for fundraising or administration costs. Whether \$1 or \$100 therefore, every little helps! Like any organization Az-Zariya (PANI) Welfare Trust has administration costs and overheads to meet. The charity runs a separate 'administration-only' account. This account has its own sources of funding.

Get In Touch

CANADA

Riyaz Visram

+1-647-203-8905

Pakistan

Aqeel Abbas

+92 300 418 18 36

www.azzariya.org

